

AP MORGAN



Porlock Crescent, Birmingham
Offers in the region of £180,000

Features:

- Two double bedrooms
- Restricted mobility shower room
- Spacious living room with bay window
- Plenty of storage

Description:

This two-bedroom, semi-detached house presents a large lounge, kitchen, two double bedrooms, spacious rear garden, a shower room, & plenty of storage.

Approaching the property, there are steps leading to the front door and side gate which gives access to the rear. The steps border a sloped front lawn laid to grass.

The ground floor immediately presents: a porch leading to the living room with space for multiple suites, an integral cupboard and fireplace with access to the kitchen. The kitchen offers plenty of counter space, an integral sink, and gas hob/electric oven. There is access to an integral cupboard space. The kitchen gives access to the rear garden and stairs to the first floor.

Ascending to the first floor, the landing presents: Bedroom One is a large double with integral storage, Bedroom Two is a further double looking to the front. The shower room is adapted for people with restricted mobility and features a washbasin, WC, and shower.

The rear garden is vast and opens to a paved patio which continues to a grass laid lawn bisected by a paved path.

Situated in Birmingham, a short drive to local amenities, this property is close to schools and supermarkets, shops, restaurants, and bars. Local public transport links are also nearby as well as the M42 allowing access to major road networks.



Details:

Porch

Living Room 14'7" x 15'7" (4.45m x 4.75m) 14'7 to Bay - Both Max

Kitchen 7'8" x 12'3" (2.34m x 3.73m) Both Max

Landing

Bedroom One 8'5" x 12'6" (2.57m x 3.8m) Both Max

Bedroom Two 10'11" x 7'10" (3.33m x 2.4m) Both Max

Shower Room 7'9" x 7'4" (2.36m x 2.24m) Both Max



EPC Rating: To be confirmed

Council Tax Band: A (tbc by solicitors).

Tenure: Freehold (tbc by solicitors).

For more information or to arrange a viewing, please call us on 0121 827 6827.

How can we help you?

Need a mortgage?

We recommend Wisser Mortgage Advice. They will search the market for you to ensure you get the right lender and mortgage deal. They typically achieve mortgage offers much more quickly than if you were dealing with lenders directly. The initial appointment is free and without obligation. Call us on 0121 827 6827, or visit their website for more information: www.wissermortgageadvice.co.uk

Property to sell?

If you need to sell a property in order to buy, you ideally need to be on the market at least (and preferably Sold STC) before viewing, otherwise you may lose out to other buyers when the right property comes along. In these circumstances we can get your property 'live' quickly. Just book a free valuation and we will visit your property and discuss your needs.

Need a solicitor?

A good solicitor can save you literally weeks of time in the buying/selling process, reducing the stress levels of all involved. We will instruct a reputable firm that is competitive on cost and very reliable. Just ask for a quote.

Need a removal company and storage?

A professional removal company takes the stress out of moving. Knowing that your belongings are safe and insured far outweighs any small savings by trying to do it yourself or using a man-and-a-van service. We work closely with and recommend Cube Removals as the leading local firm. For peace of mind and a reliable service call them on 0800 193 0000 or visit their website, cuberemovals.co.uk, to arrange a survey.

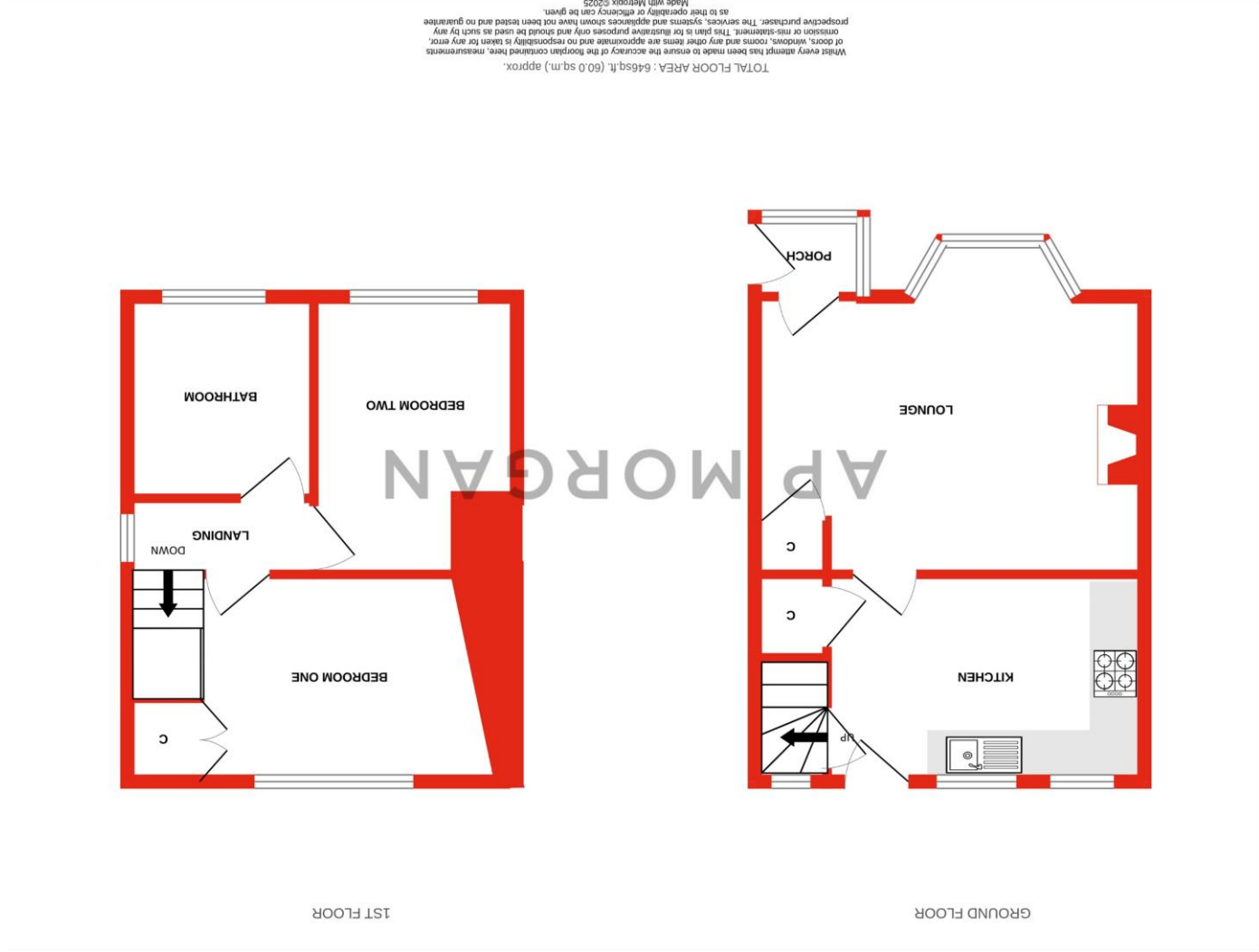

No statement in these details is to be relied upon as representation of fact, and purchasers should satisfy themselves by inspection or otherwise as to the accuracy of the statements contained within. These details do not constitute any part of any offer or contract. AP Morgan and their employees and agents do not have any authority to give any warranty or representation whatsoever in respect of this property. These details and all statements herein are provided without any responsibility on the part of AP Morgan or the vendors. Equipment: AP Morgan has not tested the equipment or central heating system mentioned in these particulars and the purchasers are advised to satisfy themselves as to the working order and condition. Measurements: Great care is taken when measuring, but measurements should not be relied upon for ordering carpets, equipment, etc. The Laws of Copyright protect this material. AP Morgan is the Owner of the copyright. This property sheet forms part of our database and is protected by the database right and copyright laws. No unauthorised copying or distribution without permission.